

Location plan of Environmental Monitoring Stations

C6 AND C7: EXISTING SEAWATER INTAKE

— : ODOLIR PATROL ROUTES FOR CONSTRUCTION PHASE

● : MONITORING STATION FOR DO MEASUREMENT FOR CONSTRUCTION PHASE

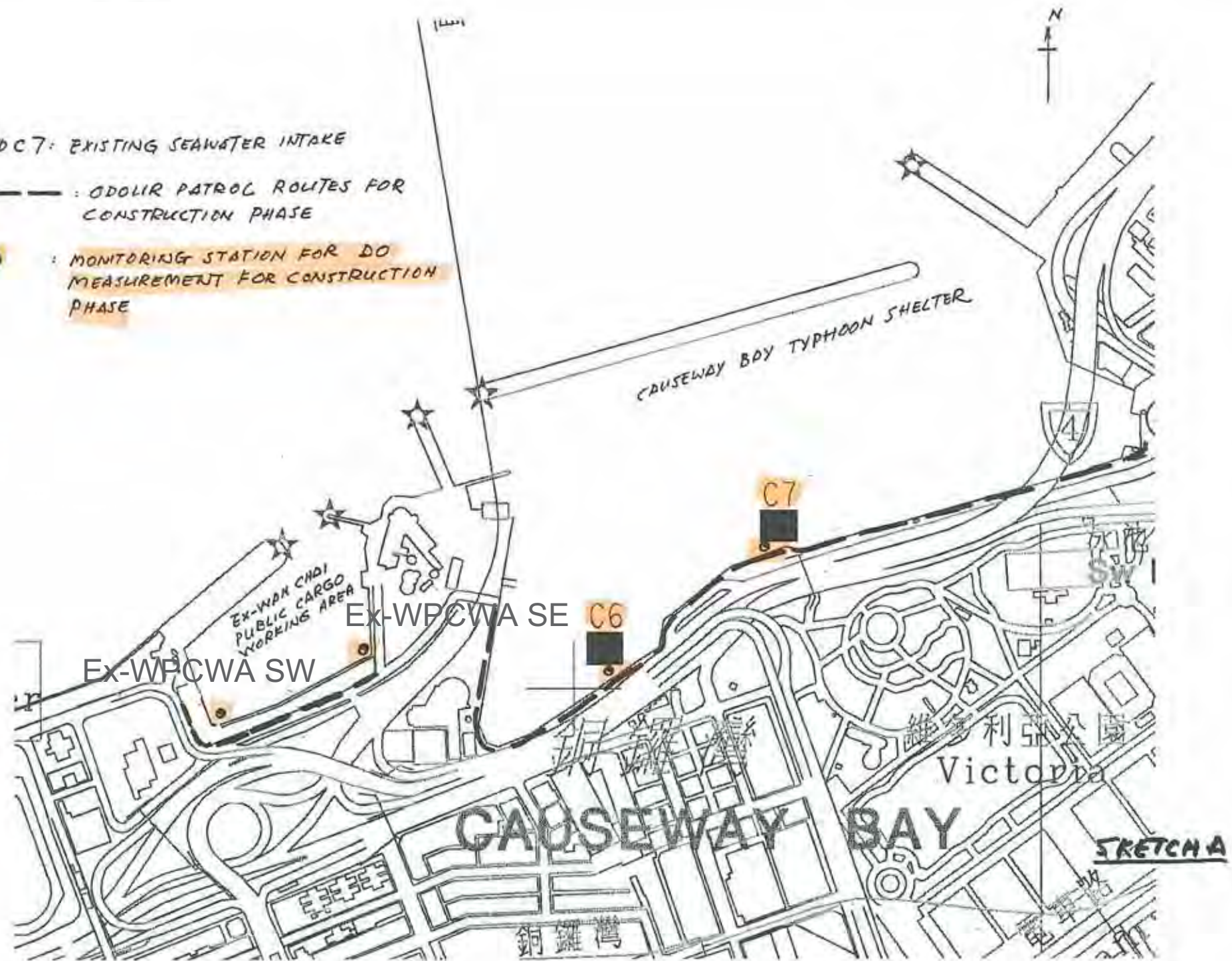

C6 AND C7: EXISTING SEAWATER INTAKE

 : ODOR PATROL ROUTES FOR CONSTRUCTION PHASE

 : MONITORING STATION FOR DO MEASUREMENT FOR CONSTRUCTION PHASE

 Odour Patrol Location

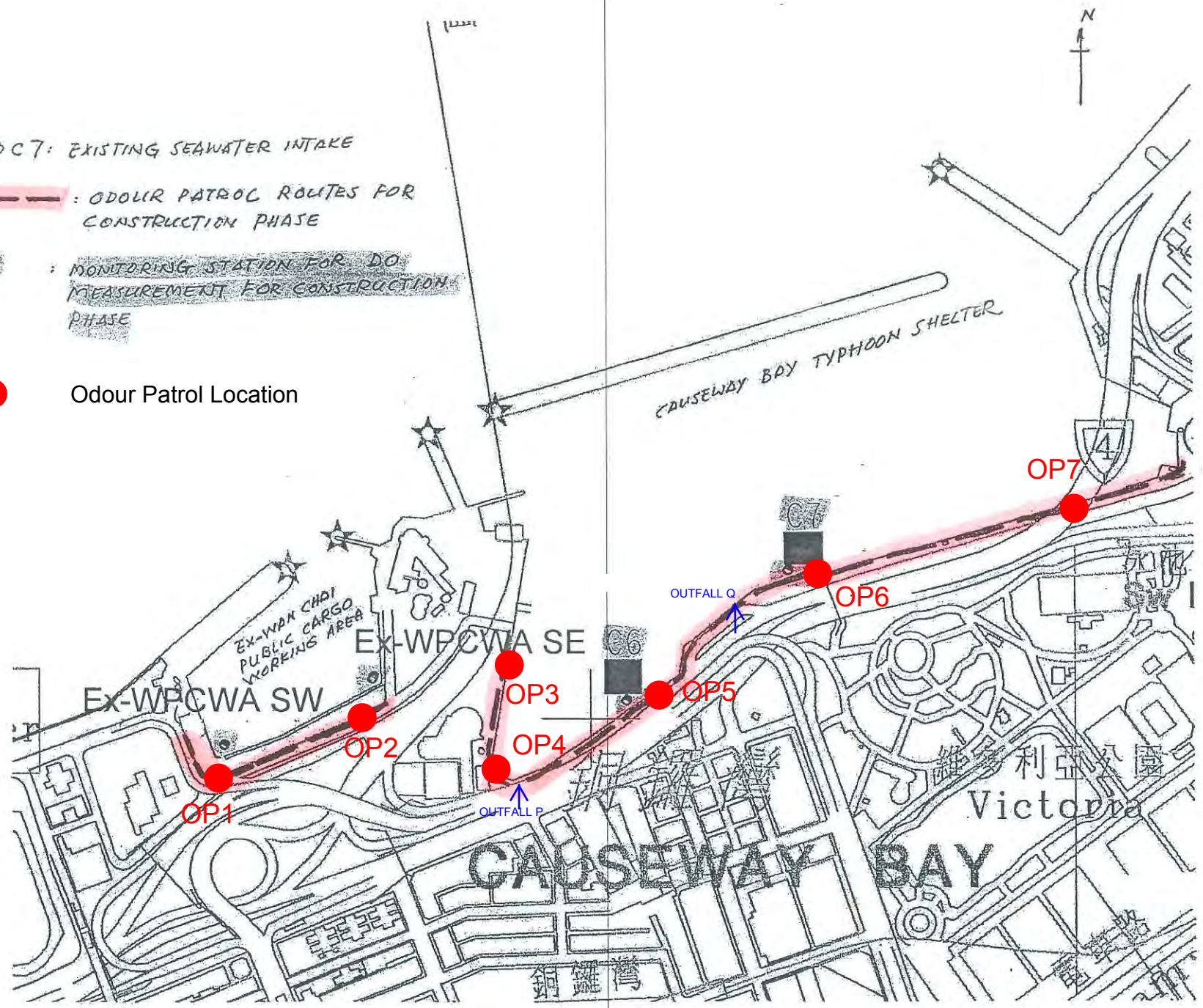

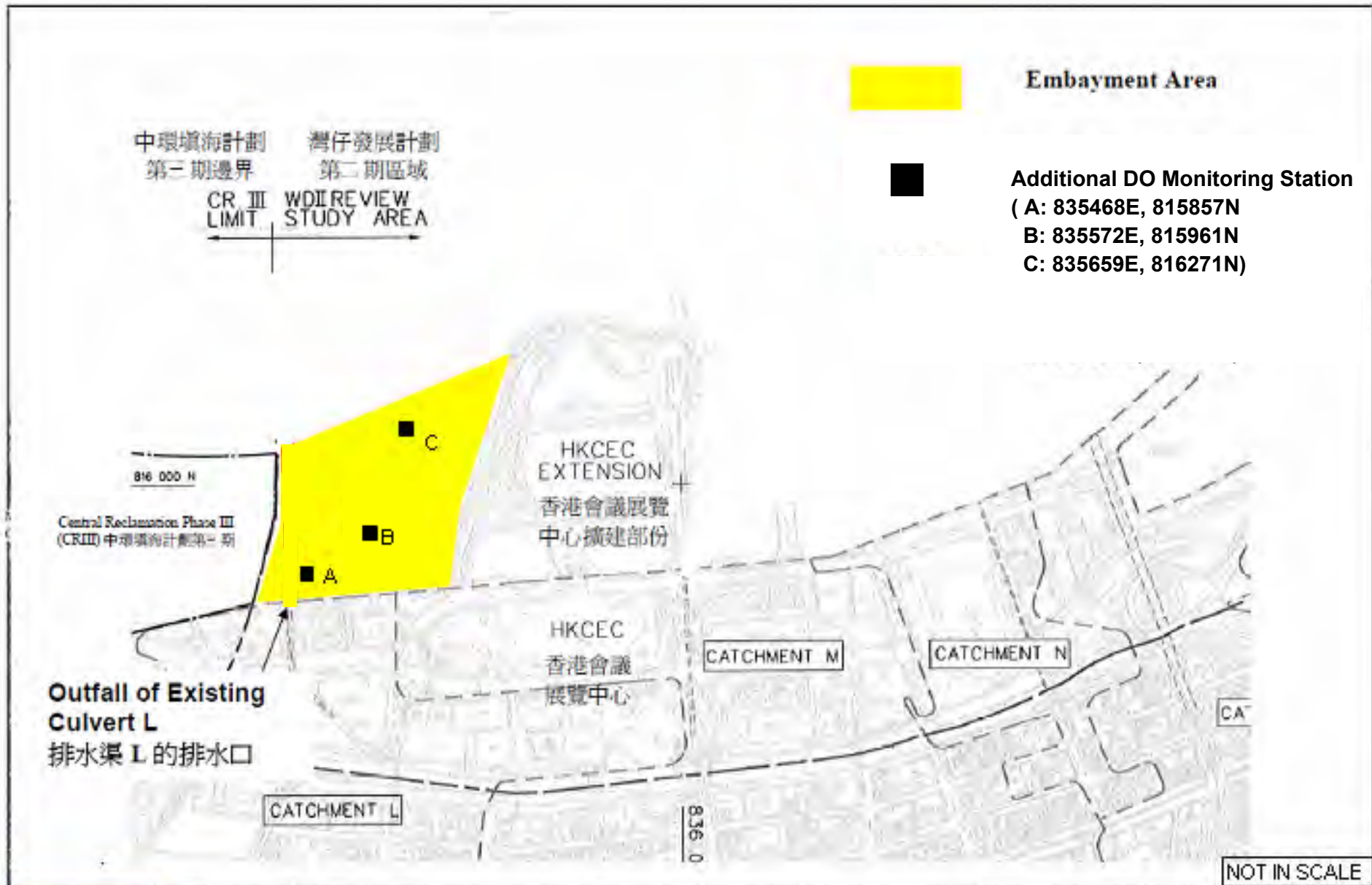

Location Plan of Additional Dissolved Oxygen Monitoring Stations for Culvert L Water Discharge Flow

Legend

- ◆ Water Quality Monitoring Stations
- C1 Hong Kong Convention and Exhibition Centre Extension
- C2 Telecom House/ HK Academy For Performing Art/ Shui On Centre
- C3 Hong Kong Convention and Exhibition Centre Phase 1
- C4 Wan Chai Tower and Great Eagle Centre
- C5 Sun Hung Kai Centre
- C6 Proposed Exhibition Station/ World Trade Centre
- C7 Windsor House
- C8 City Garden
- C9 Provident Centre

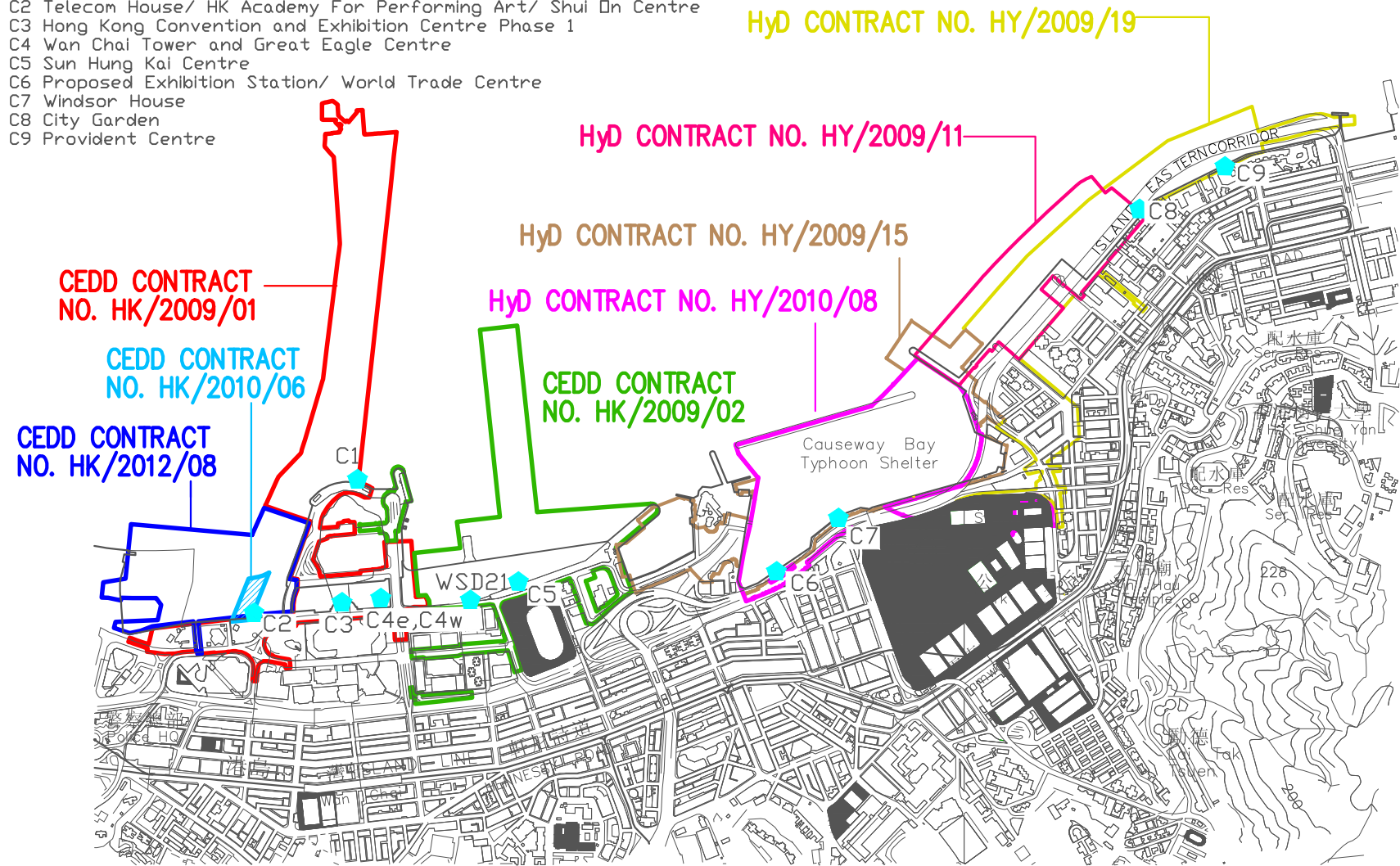

LOCATIONS OF WATER QUALITY MONITORING STATIONS

Legend

- ◆ Water Quality Monitoring Stations
- RW21-P789 (Wanchai WSD intake/ Great Eagle Centre/ China Resources Centre/ Sun Hung Kai Centre)
- C1 Hong Kong Convention and Exhibition Centre Extension
- P1 Hong Kong Convention and Exhibition Centre Phase 1
- P3 HK Academy For Performing Art
- P4 Shui On Centre
- P5 Government buildings (Wanchai Tower/ Revenue Tower/ Immigration Tower)
- C6 Proposed Exhibition Station/ World Trade Centre
- C7 Windsor House

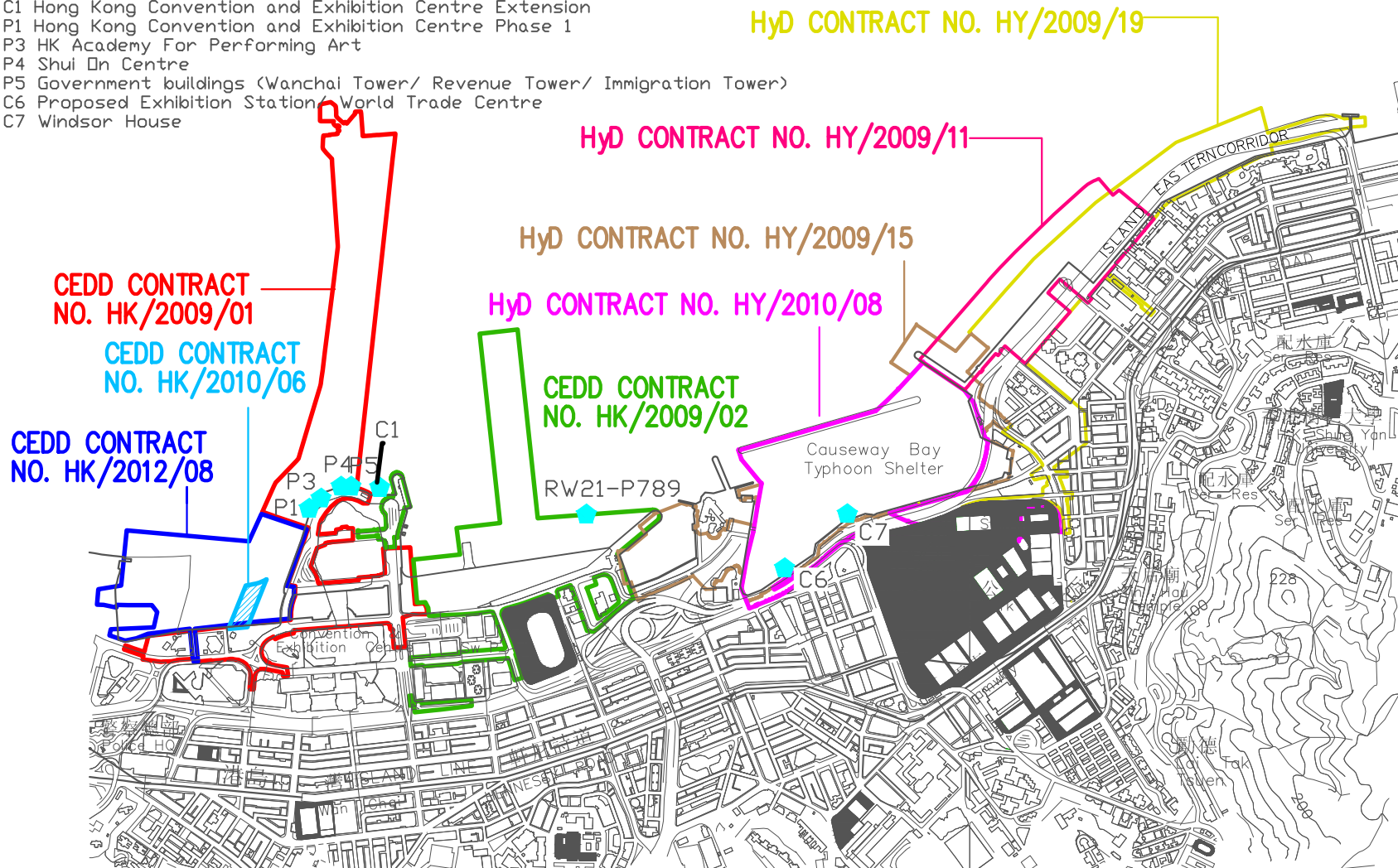

LOCATIONS OF WATER QUALITY MONITORING STATIONS

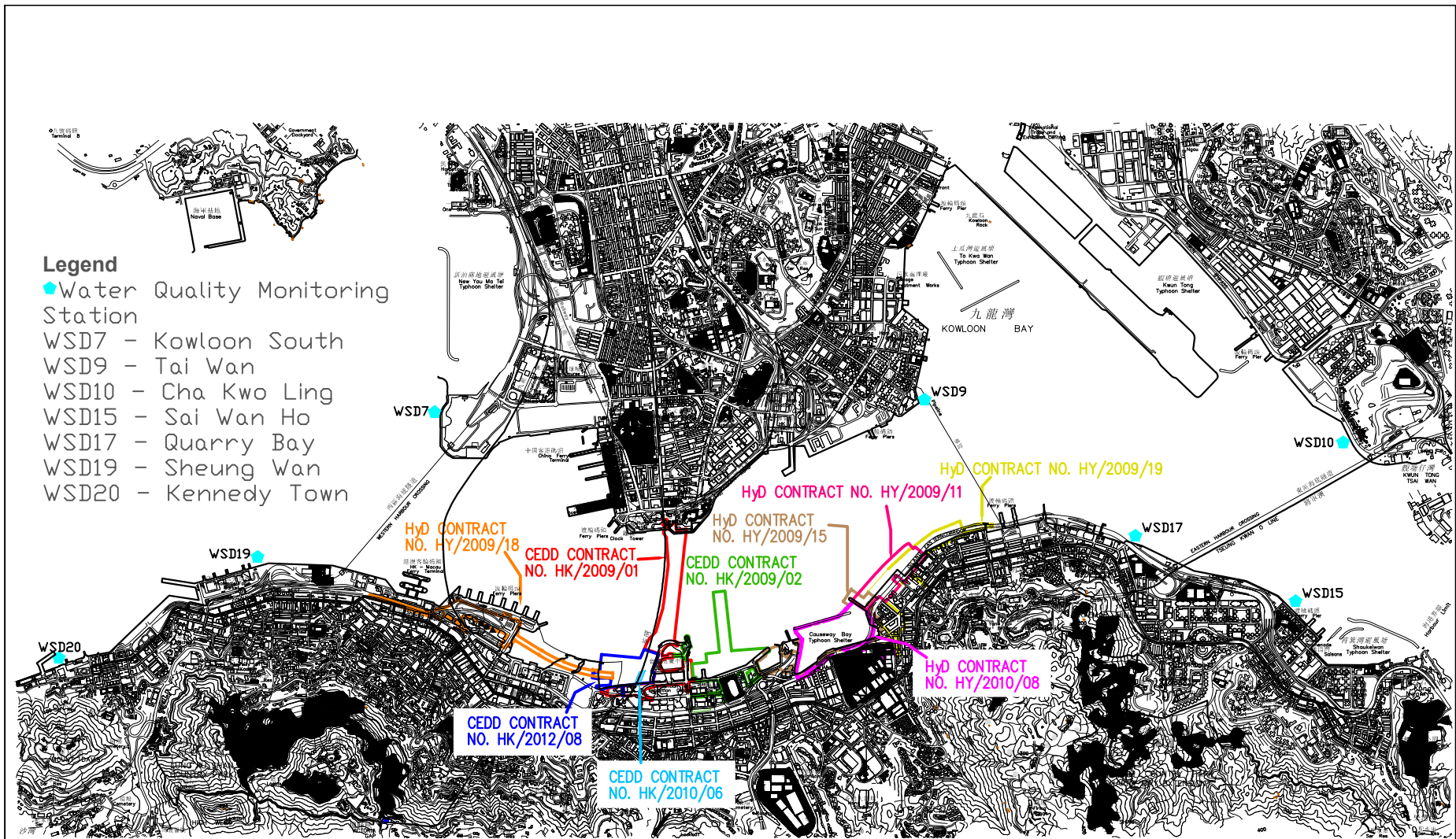

LOCATIONS OF WATER QUALITY MONITORING STATIONS

Legend

- Additional □ Monitoring Station

CEDD CONTRACT
NO. HK/2012/08

CEDD CONTRACT
NO. HK/2010/06

CEDD CONTRACT
NO. HK/2009/01

CEDD CONTRACT
NO. HK/2009/02

HyD CONTRACT
NO. HY/2009/15

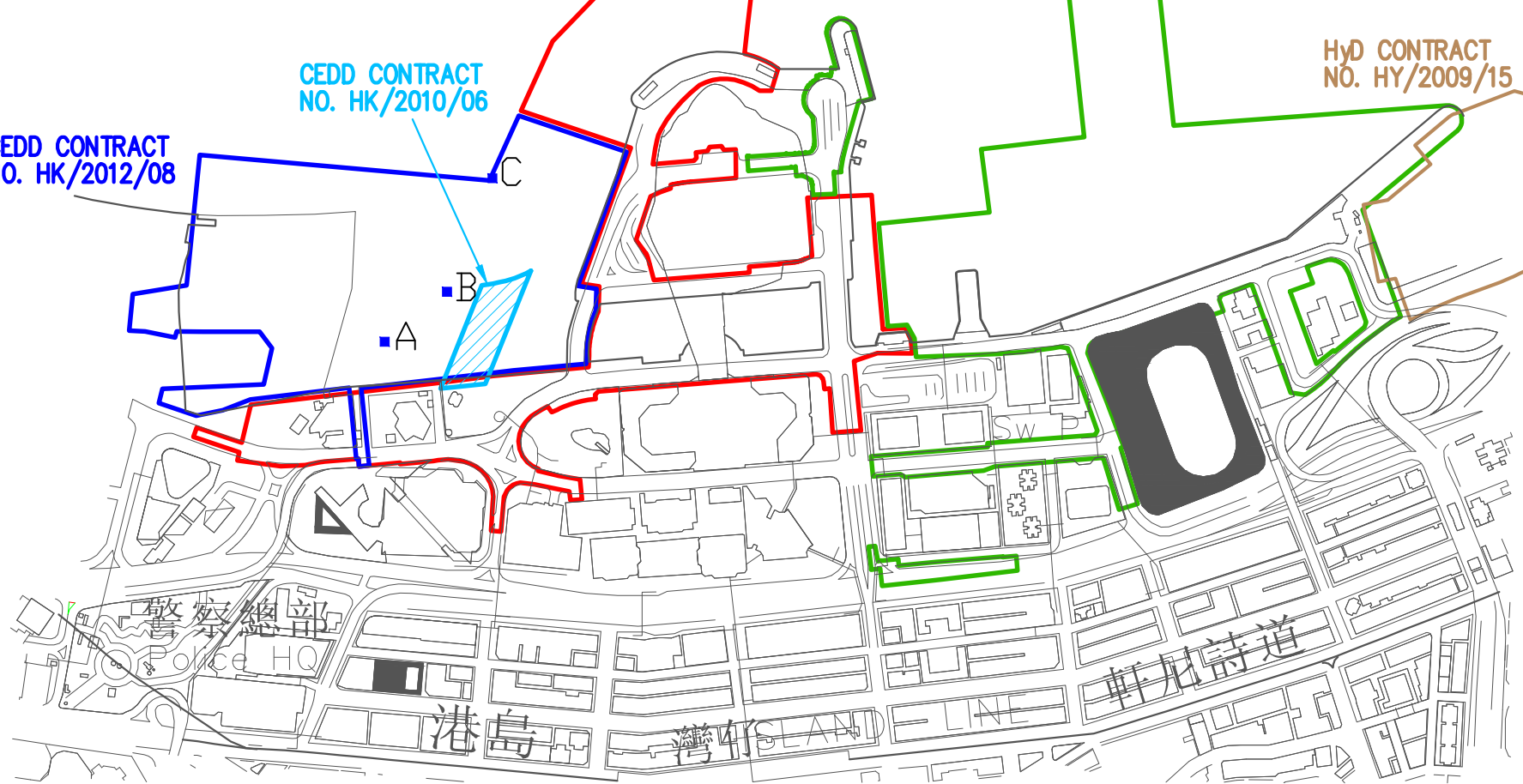

**LOCATIONS OF ADDITIONAL DISSOLVED OXYGEN MONITORING STATIONS
FOR CULVERT L WATER DISCHARGE FLOW**